

# MAIN LEVEL

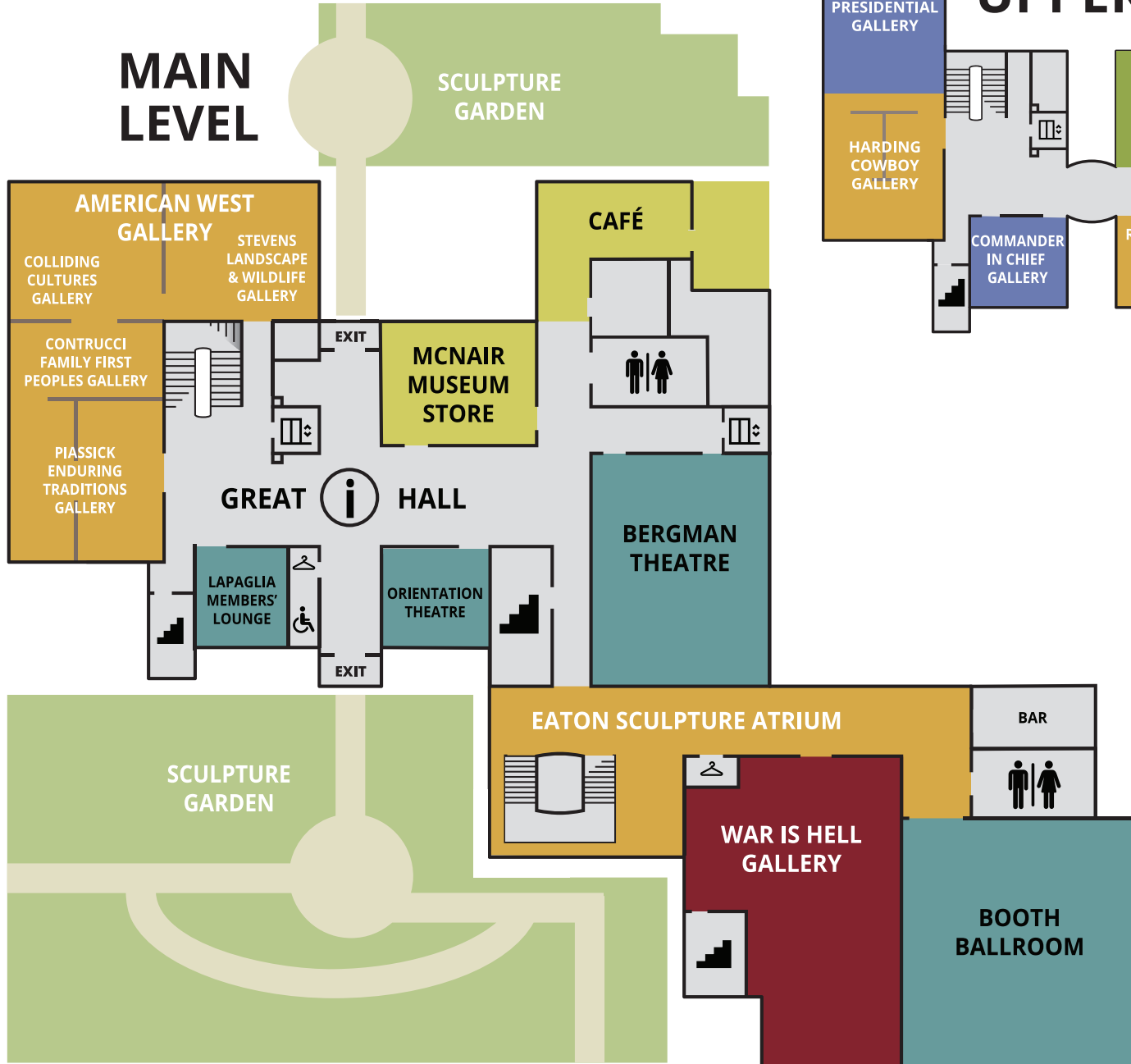

# UPPER LEVEL

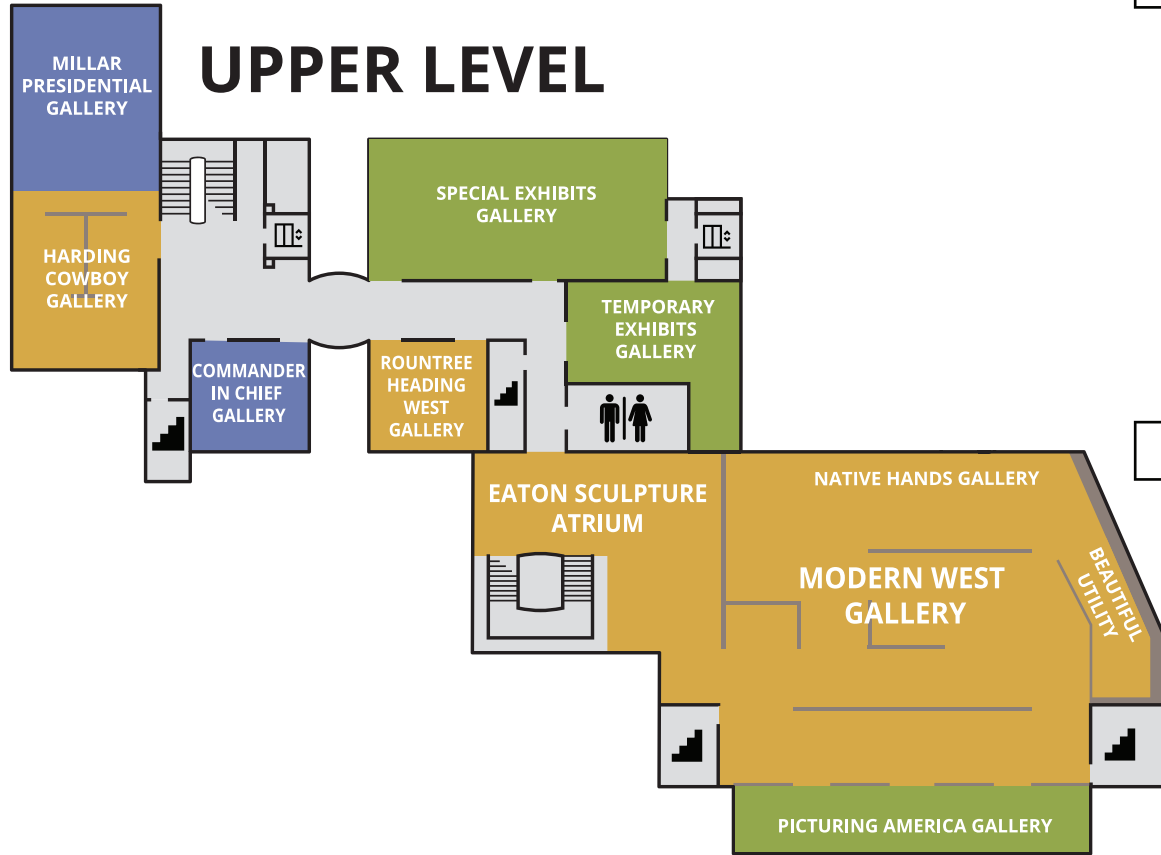

# LOWER LEVEL

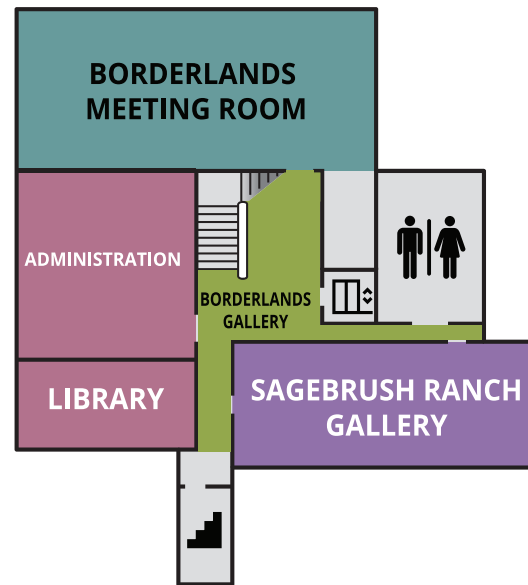

## UPPER

- Picturing America Gallery:** Fine art and documentary photography.
- Native Hands Gallery:** More than 150 American Indian artifacts.
- Beautiful Utility:** Decorated cowboy objects.
- Modern West Gallery:** Contemporary paintings and sculpture.
- Neva & Don Rountree Heading West Gallery:** Americans on the move.
- Pete & Julie Contrucci Family First Peoples Gallery:** America's original inhabitants.
- Frank Harding Cowboy Gallery:** Cowboys at work, rest and play.
- Carolyn & James Millar Presidential Gallery:** Original letters and photographs by every president.

## MAIN

- War is Hell Gallery:** Contemporary Civil War art.
- Lucinda & James Eaton Sculpture Atrium:** Sculpture, traditional on the Main Level and contemporary on the Upper Level.
- Frank A. Bergman Theatre:** Hosts lectures and demonstrations.
- Orientation Theatre:** "The American West" runs every 20 minutes.
- Peter S. LaPaglia Members Lounge:** Relax and see doodles left by visiting artists.
- Karen & Joel Piassick Enduring Traditions Gallery:** The roots of Western art.
- American West Gallery:** Traditional Western paintings & sculpture by historic & contemporary artists.
- Joyce & John Stevens Landscape and Wildlife Gallery:** The vast landscape and the animals of the West.
- Candace Alexander McNair Store:** Books, art, children's items and more.
- The Café:** Open Tuesday through Saturday 10:30 am to 3:30 pm.

## LOWER

- Borderlands Gallery:** Special exhibition space.
- Sagebrush Ranch Gallery:** Hands-on, interactive gallery for children.
- Research Library & Administrative Offices:** Please make appointment.

## MAP KEY

- |  |                   |  |                  |
|--|-------------------|--|------------------|
|  | KID'S AREA        |  | GRAND STAIRCASES |
|  | SPECIAL EXHIBITS  |  | BATHROOMS        |
|  | PRESIDENTIAL      |  | EMERGENCY STAIRS |
|  | WESTERN           |  | ELEVATOR         |
|  | CIVIL WAR         |  | COATS            |
|  | CAFÉ & STORE      |  | INFORMATION      |
|  | PROGRAMMING AREAS |  | WHEELCHAIRS      |
|  | ADMINISTRATIVE    |  |                  |